



# Community Meeting

Green Bay Area Public Schools  
Facilities Master Planning



## Introductions:

1. Dr. Michelle Langenfeld
2. Joe Donovan

## CURRENT REALITY: THE “WHY?”

- Crowding on the East Side
- Capacity on the West Side
- Growth on the East Side
- Projected Growth
- Space needs for programs and services
- Changing educational landscape
  - Open Enrollment - inter and intra district
  - Mobility
  - Vouchers
- Renting Space
- Equity and Access
- Safety
- 21st Century - flexible learning spaces

# introduction

## DESIRED STATE - Guiding Principles

SOLUTIONS *will be ...*

- Aligned to the district's mission, vision, and strategic priorities including:
  - **ACADEMIC EXCELLENCE, PERSONALIZED PATHWAYS, ENGAGEMENT and THRIVING WORKFORCE**
- Responsive to the needs/ current reality identified by students, staff, parents and community
- Responsive to the future needs identified by students, staff, parents and community
- Equitable for ALL
- Fiscally sound
- Flexible spaces that can expand/contract, taking into account enrollment shifts

# introduction

## OBJECTIVES FOR OUR TIME TOGETHER...

- Develop a shared understanding of:
  - Facility challenges/ options across the district
  - Flexible school designs
- Provide information to the Board and Facilities Task Force re: facility challenges
- Leave with an understanding of the next steps

# introduction

## OBJECTIVES FOR OUR TIME TOGETHER...

- *Now that you have learned about the district's facility challenges, about flexible school design, and about the Board's efforts to address challenges, we have a **very general question**: What do you think? What are your reactions to what we have covered tonight?*
- As Board members continue their facility-related work, what do you want the Board to keep in mind? What do you think is important for the Board to consider?
- What do you think? What additional information are you looking for as it relates to this topic?
- *School Board members have made clear that they are interested in your thoughts and feedback.* What additional information would you like to provide them? What have we missed?

## Upcoming Activities:

Community-led Facilities Task Force to meet in October.

Community survey will be conducted in November.

To provide additional feedback, visit our website and complete form:

[http://www.gbaps.org/our\\_district/envisioning\\_a\\_brighter\\_future/](http://www.gbaps.org/our_district/envisioning_a_brighter_future/)

# District Master Plan

# The Master Planning Process

creativity | collaboration | dedication



# district facilities master plan



Master Planning and Community Engagement



# district facilities master plan

## Phase 1 - Learn:

1. Visited each school and met with building leadership
2. Establish functional capacities
3. Enrollment projections
4. Visioning sessions with Board of Education, Parents Advisory Group and District Administration
5. Statewide tour of recently constructed educational facilities
6. Some community meetings

# district facilities master plan

## Phase 2 - Create:

1. Community Engagement Sessions
2. Facilities Task Force
3. Options Development and Review
4. Community Survey
5. Recommendation to the Board of Education
6. Board Review and Possible Action

# District Master Plan

## Current Facility Challenges

creativity | collaboration | dedication

# historic membership

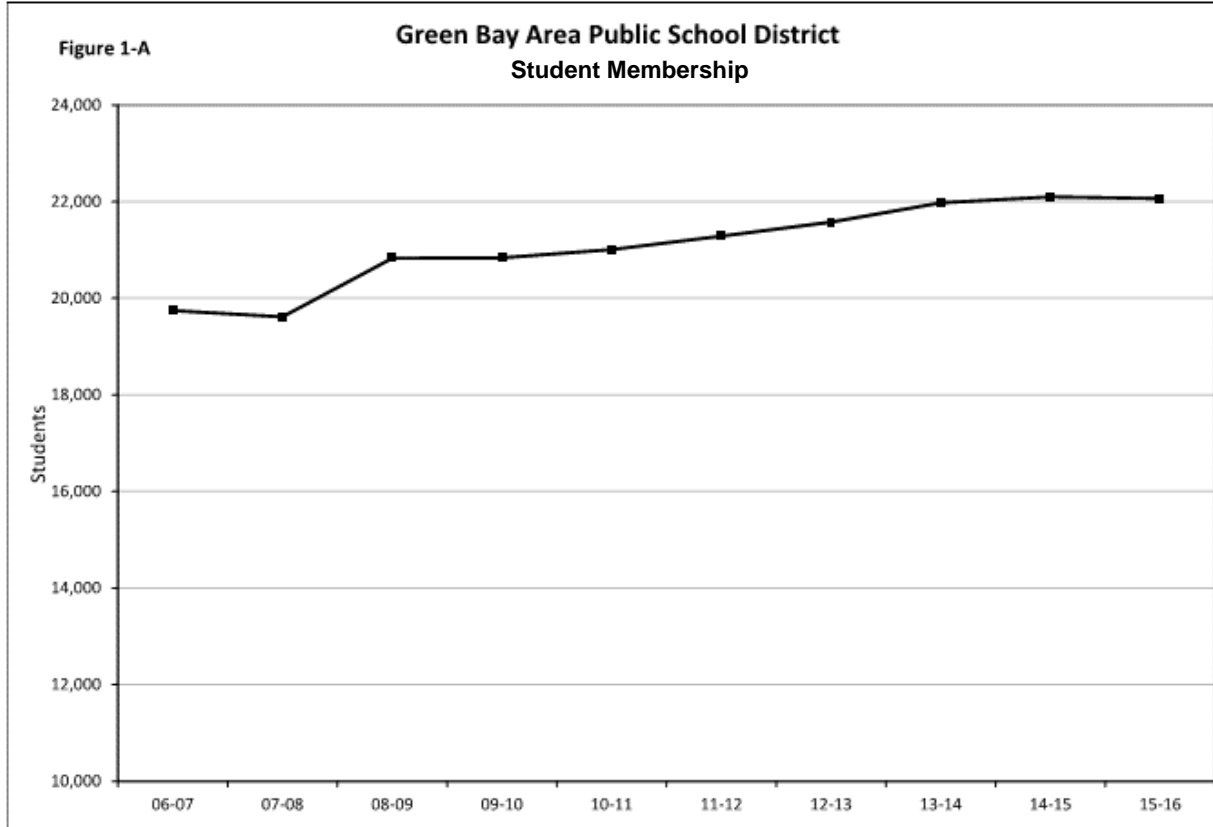

Data Source: APL Report, March 2016

# historic enrollment

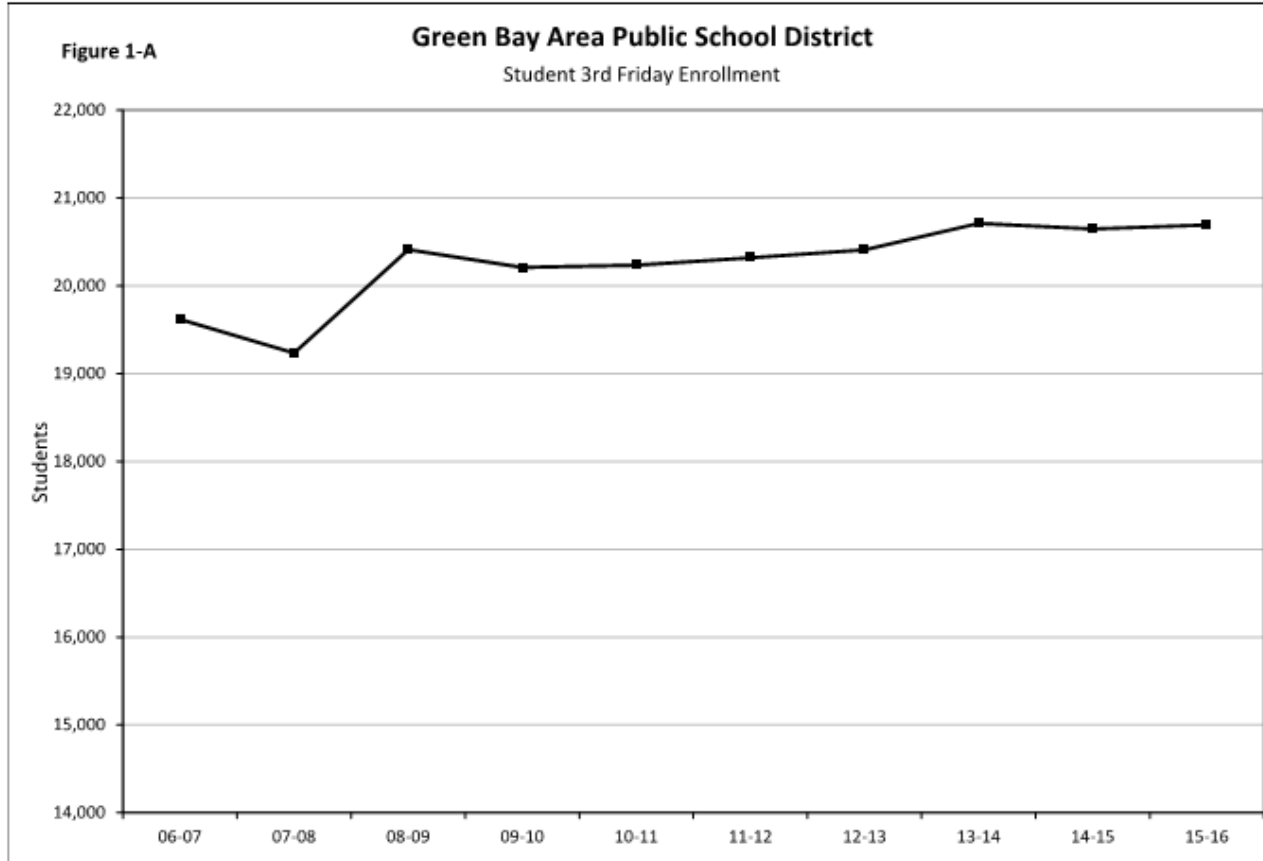

Data Source: APL Report, September 2016

# projected membership

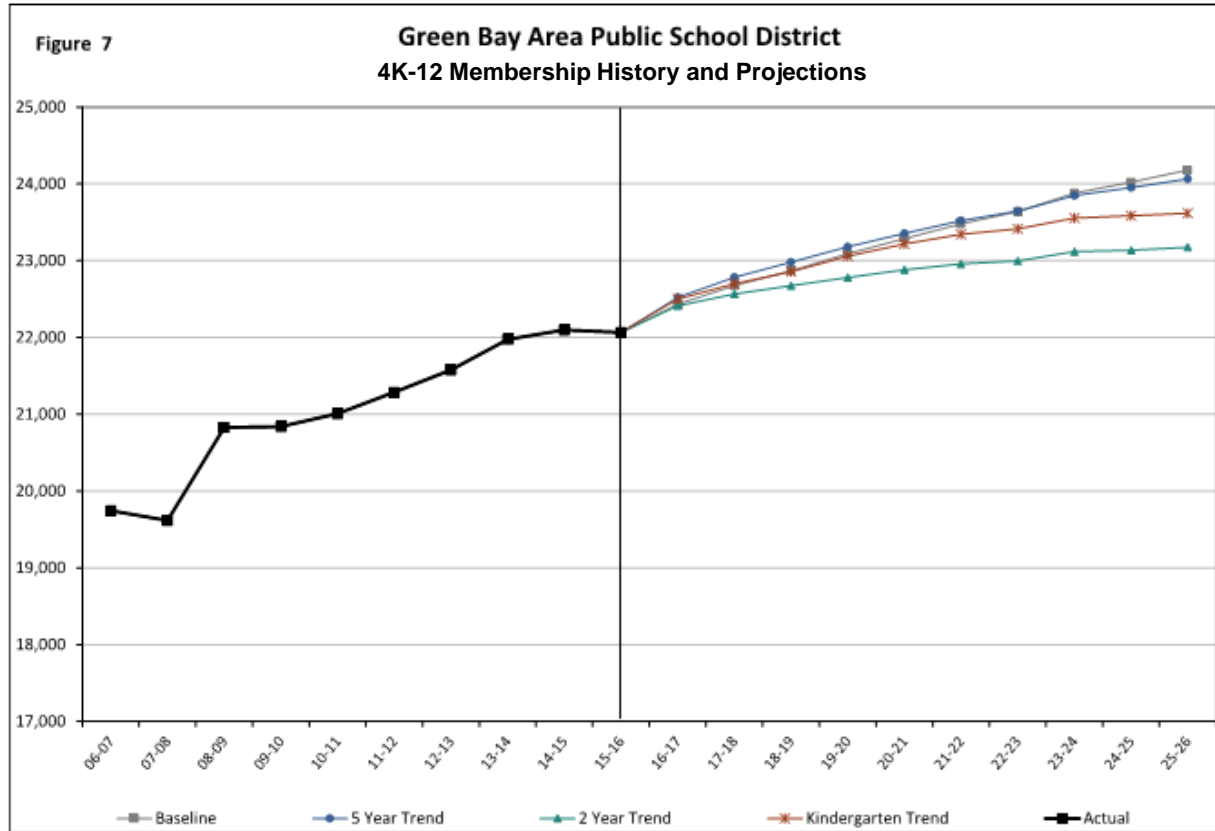

Data Source: APL Report, March 2016

# projected enrollment

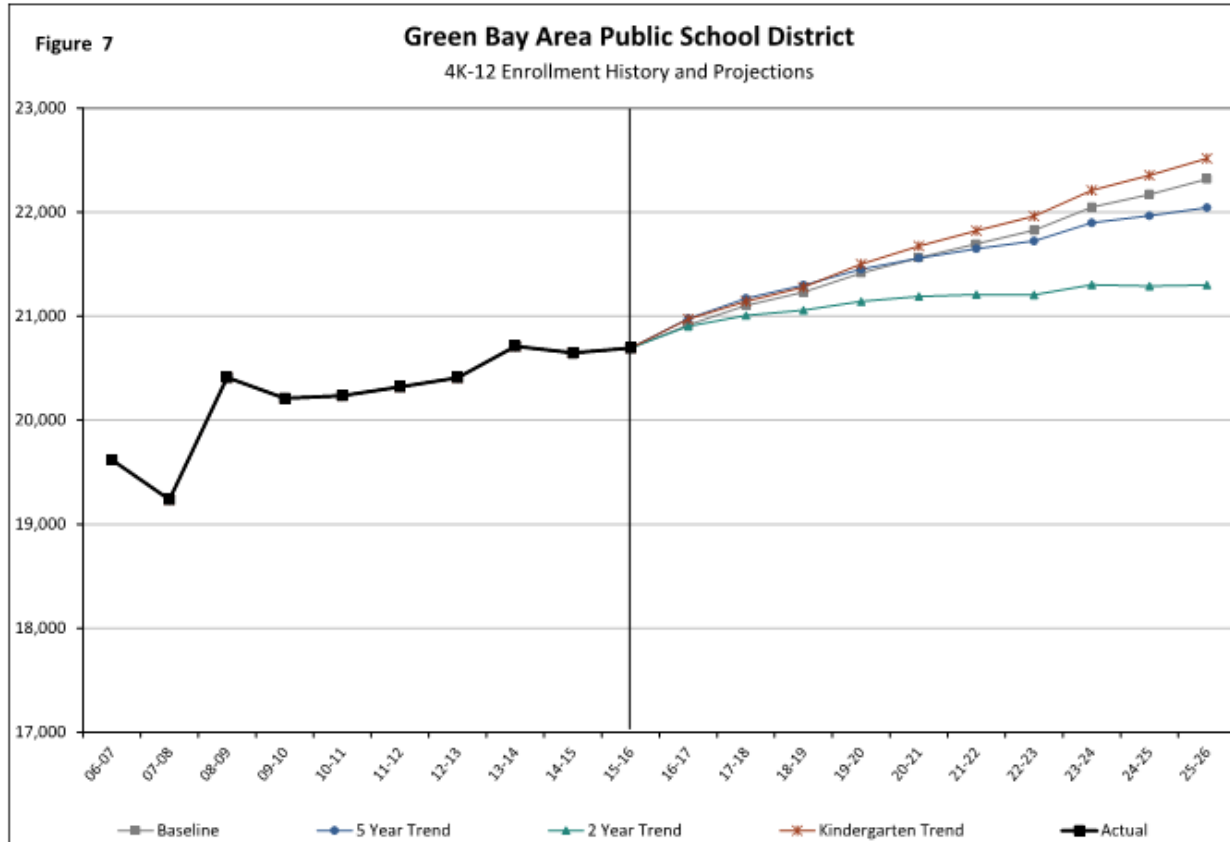

Data Source: APL Report, September 2016



# Enrollment

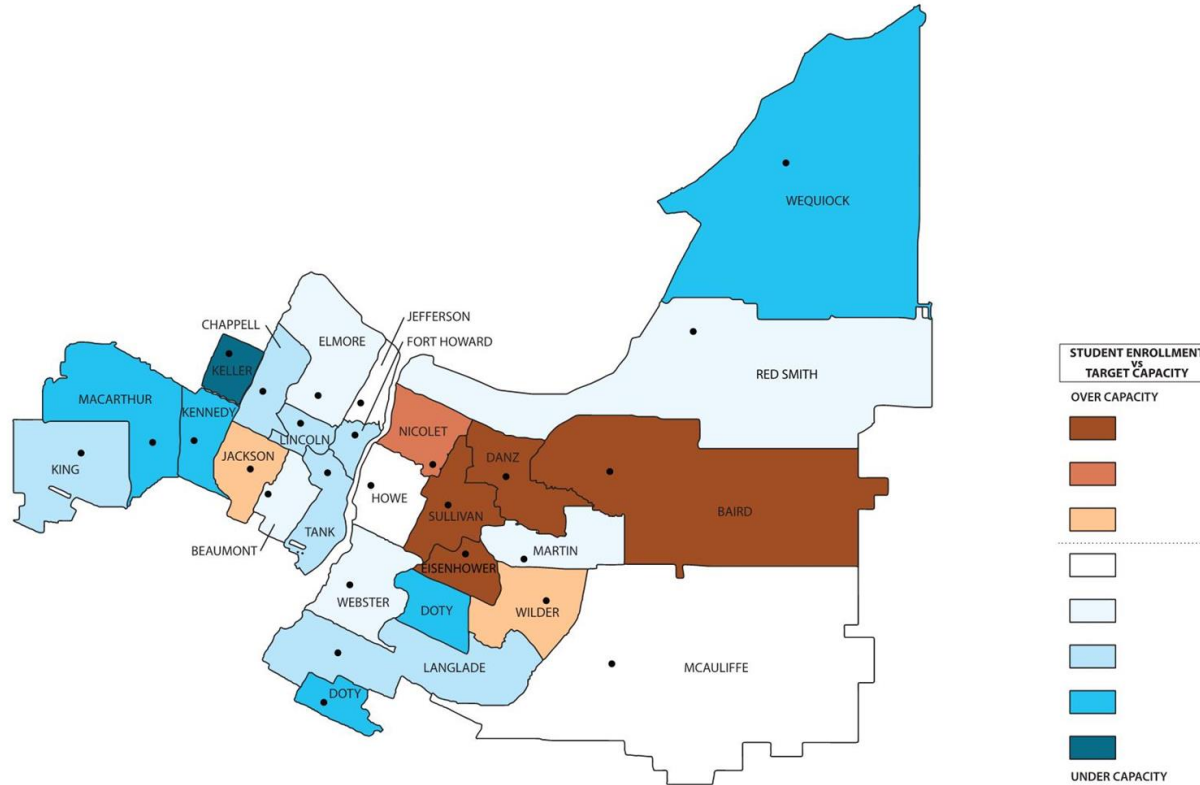

7/8/21

## Projected Elementary Capacity – 2020/21

# Enrollment

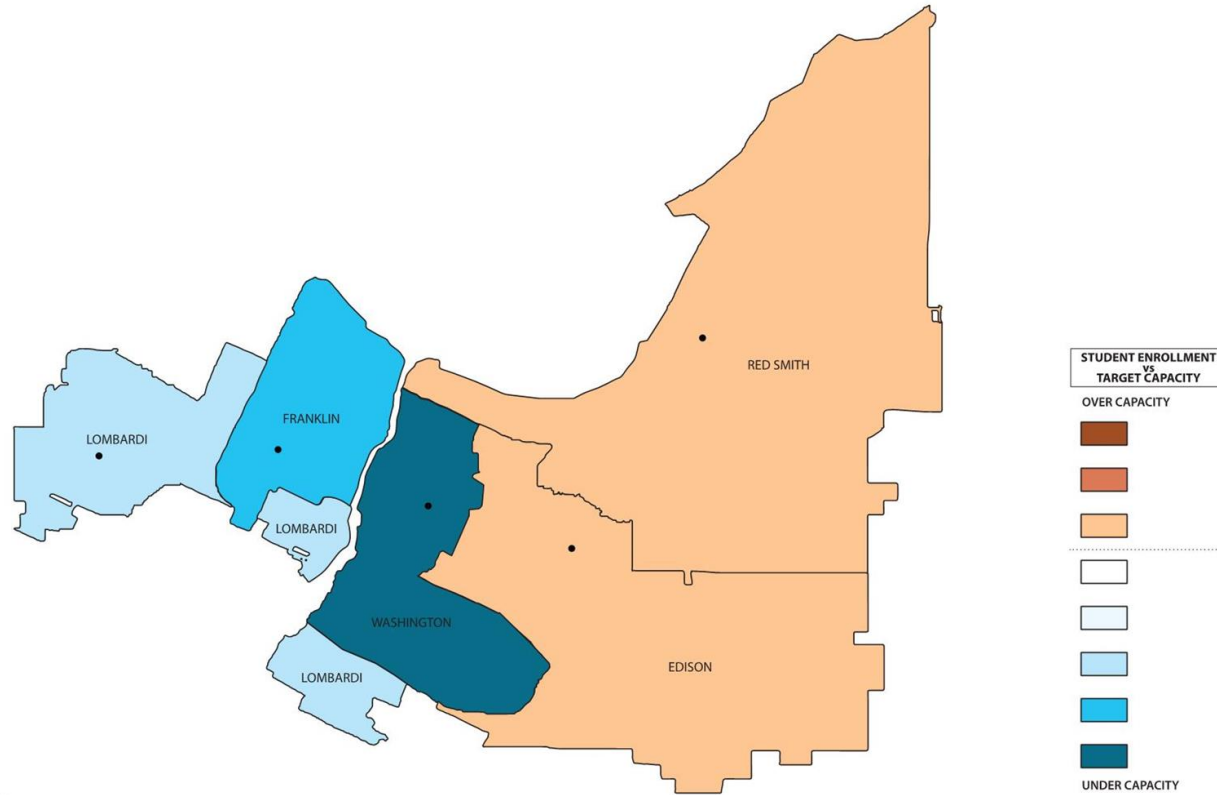

Projected Middle School Capacity – 2020/21

# Enrollment

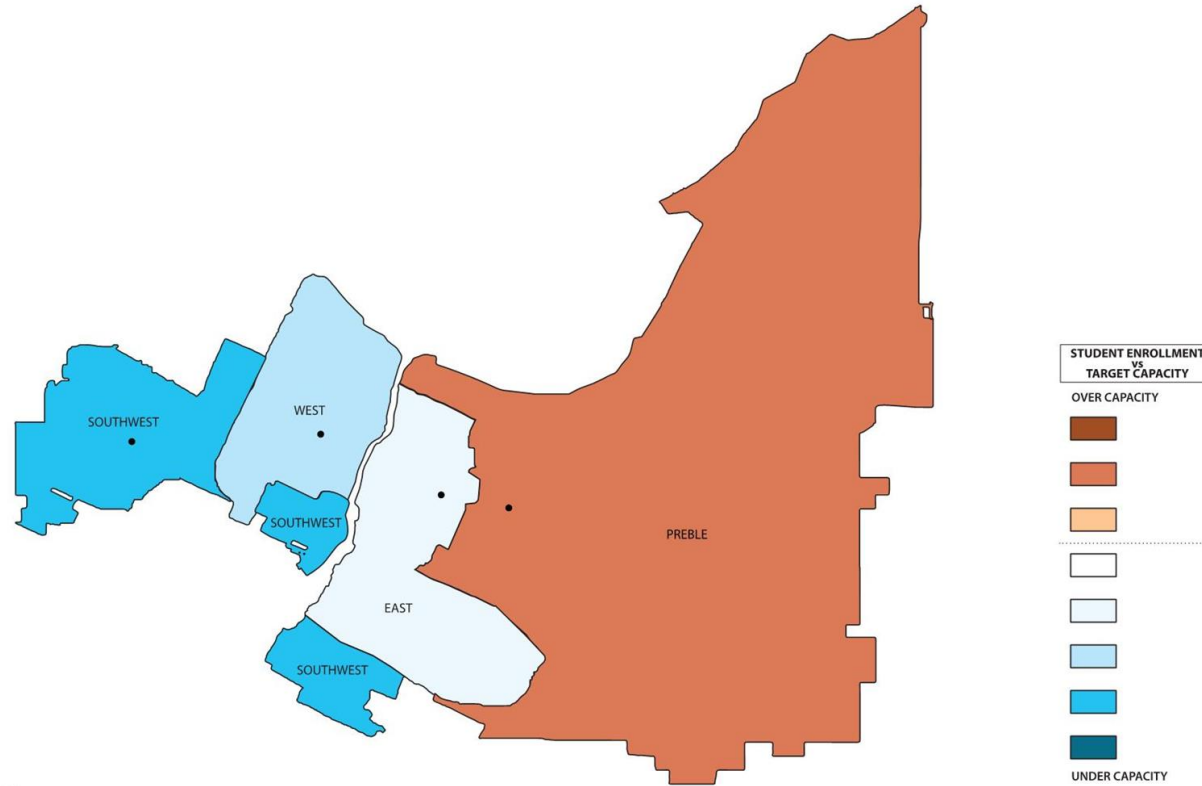

18-01

## Projected High School Capacity – 2020/21

# current facility challenges

## Diversity of programming

More programming occurring in buildings that were not designed to accommodate it:

- Social programs
- English as a Second Language learners
- Special Education Needs
- More personalized learning



# current facility challenges

## Personalized learning

Educational delivery has changed:

- Most buildings were built for a different time



# what is personalized learning?

- An approach to learning and instruction that is designed around individual learner readiness, strengths, needs and interests.
- Learners are active participants in setting goals, planning learning paths and determining how learning will be demonstrated.
- Learning objectives, content, methods and pacing are likely to vary from learner to learner.

Adapted from the CESA 1 Institute for Personalized Learning

# best practices of personalized learning

- Students and teachers focus on the process of becoming highly skilled learners who can effectively access and use content.
- Personalized learning environments need to be conducive to working collaboratively and flexibly, as opposed to one-way receiving of subject material.



# learning today for tomorrow

- Today's schools cannot predict or control the future demands for career and college readiness... teaching students “how” to learn provides them with the skills and strategies to compete in an ever-changing world.
- The educational environment is critical for students to develop a sense of agency and efficacy towards learning.



# District Master Plan

## Learning Environments

creativity | collaboration | dedication

# evolution of learning

## A Brief History of School Design

### 1920's – Industrial Model

- Schools designed to reflect modern thinking
- Standardized thinking and teaching
- Efficient – students trained for a repetitious industrial world
- Not flexible



# evolution of learning

## A Brief History of School Design

### 1960's – Experiment in Open Concept

- Movement began in the UK
- Reaction to standardized teaching and learning
- Thought was students learned better outside of the “box”
- Multi-age / multi-instructor organization
- Building design did not synch with teaching and learning



# evolution of learning

## 1990s classroom



# evolution of learning

## A Brief History of School Design

### 2000's – Student Centered Learning

- Digitally connected world transforms education
- Students learn anytime, anywhere
- Technology allows for greater individualization
- Spaces become multipurpose and more flexible
- Greater variety of learning environments available



# evolution of learning

## Various Settings and Context

- Different places for learning
- Self learning vs. organized learning
- Multiple learning styles



# transforming the learning environment

## Breakout Areas/Transition Spaces

- Enable team teaching/learning
- Enable project-based learning
- May be used by small or large groups
- Enrichment spaces



# transforming the learning environment

## Current Space Configuration

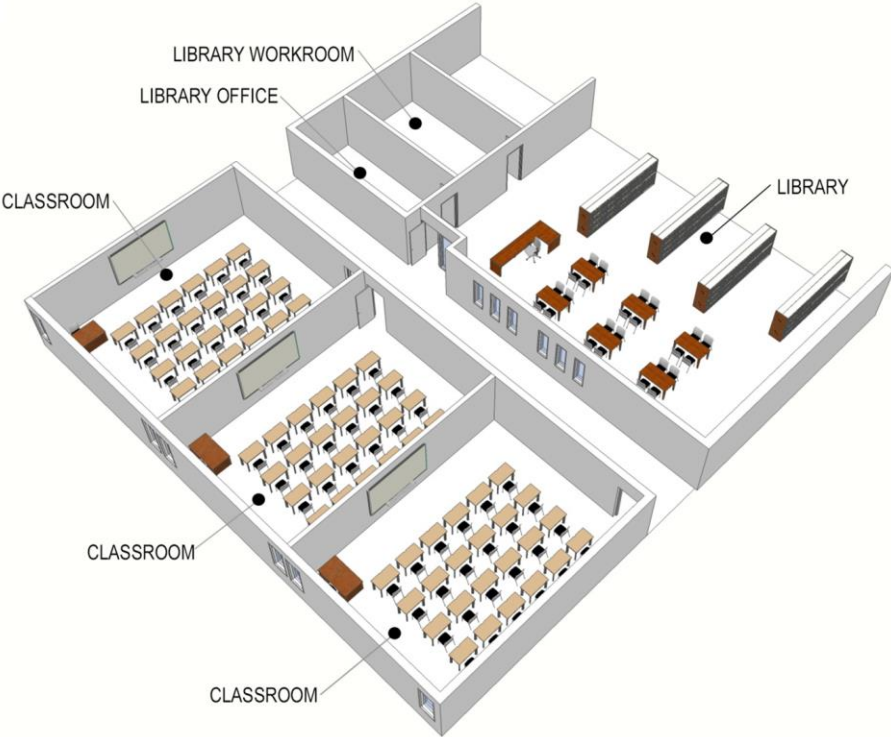

## Reconfigured Space

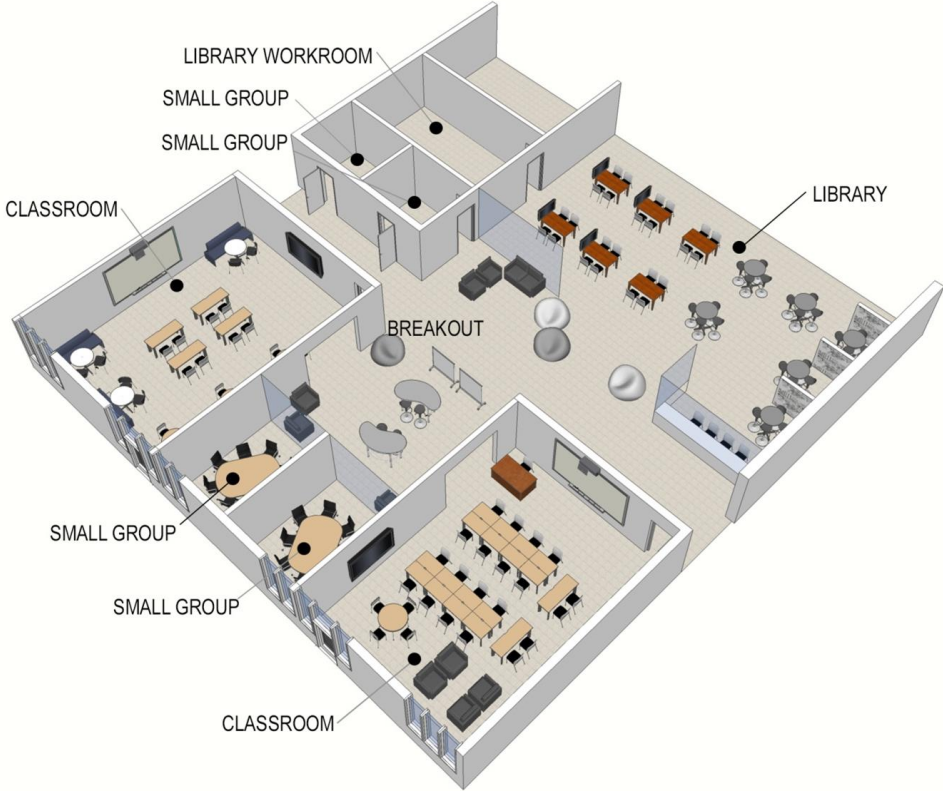



# Chappell Elementary



# Chappell Elementary



# Leonardo da Vinci



# Leonardo da Vinci



# Leonardo da Vinci



# East High School



# East High School



# District Master Plan

# Community Conversation

creativity | collaboration | dedication



# conclusion

## Upcoming Activities:

Community-led Facilities Task Force to meet in October.

Community survey will be conducted in November.

To provide additional feedback, visit our website and complete form:

[http://www.gbaps.org/our\\_district/envisioning\\_a\\_brighter\\_future/](http://www.gbaps.org/our_district/envisioning_a_brighter_future/)